

R.D. Forsythe
 R.D. FORSYTHE
 Acting City Engineer
 Civil Eng. Cert. 1P3102

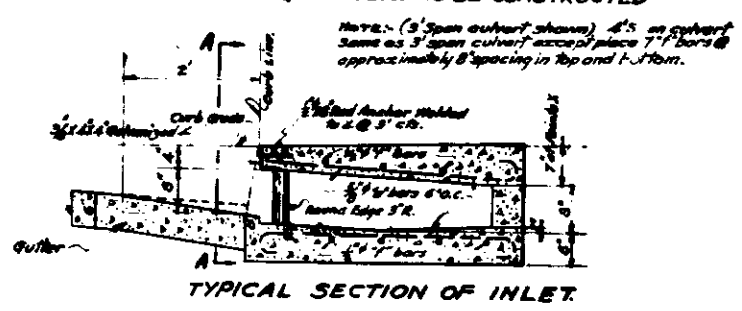

NOTE: Top of Culvert in sidewalk Area to conform to cross slope and finished grade and marking of sidewalk, opening thru curb to have corners rounded with a 3" radius.

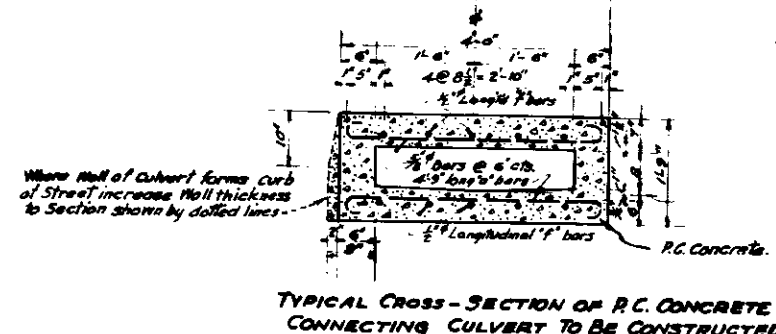
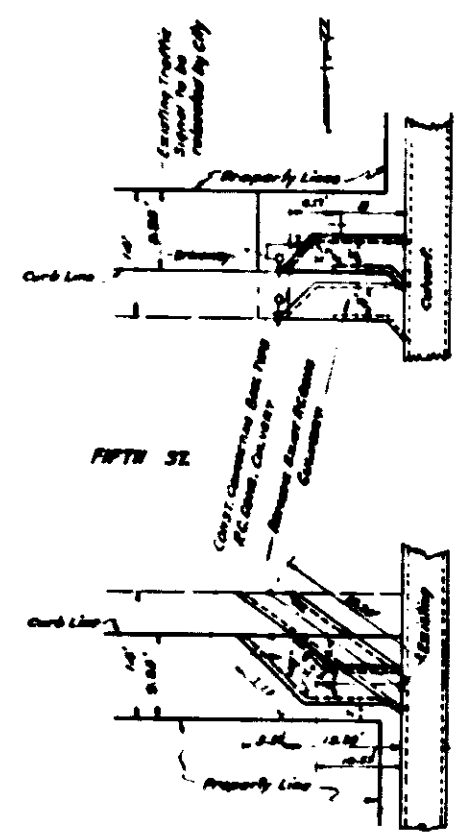
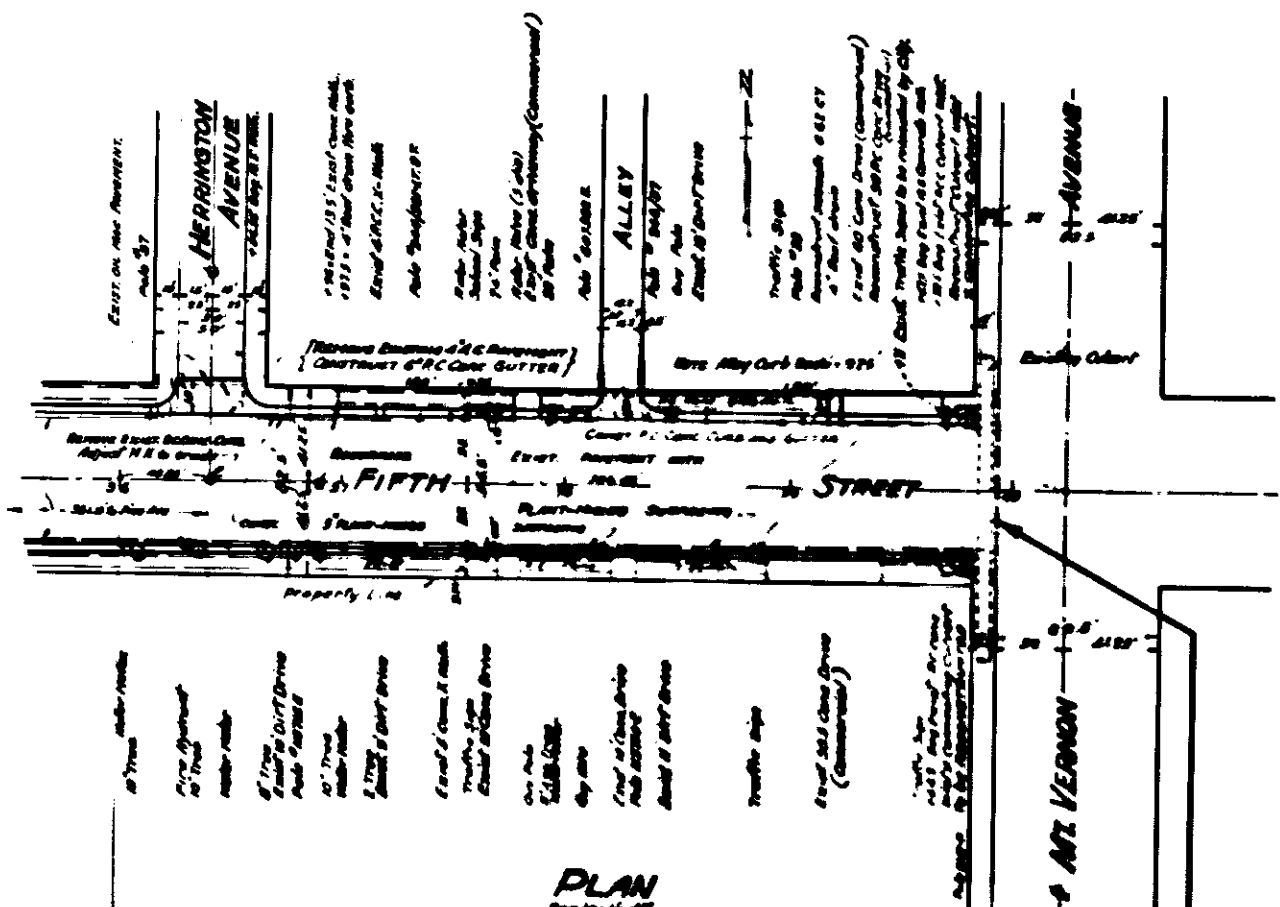
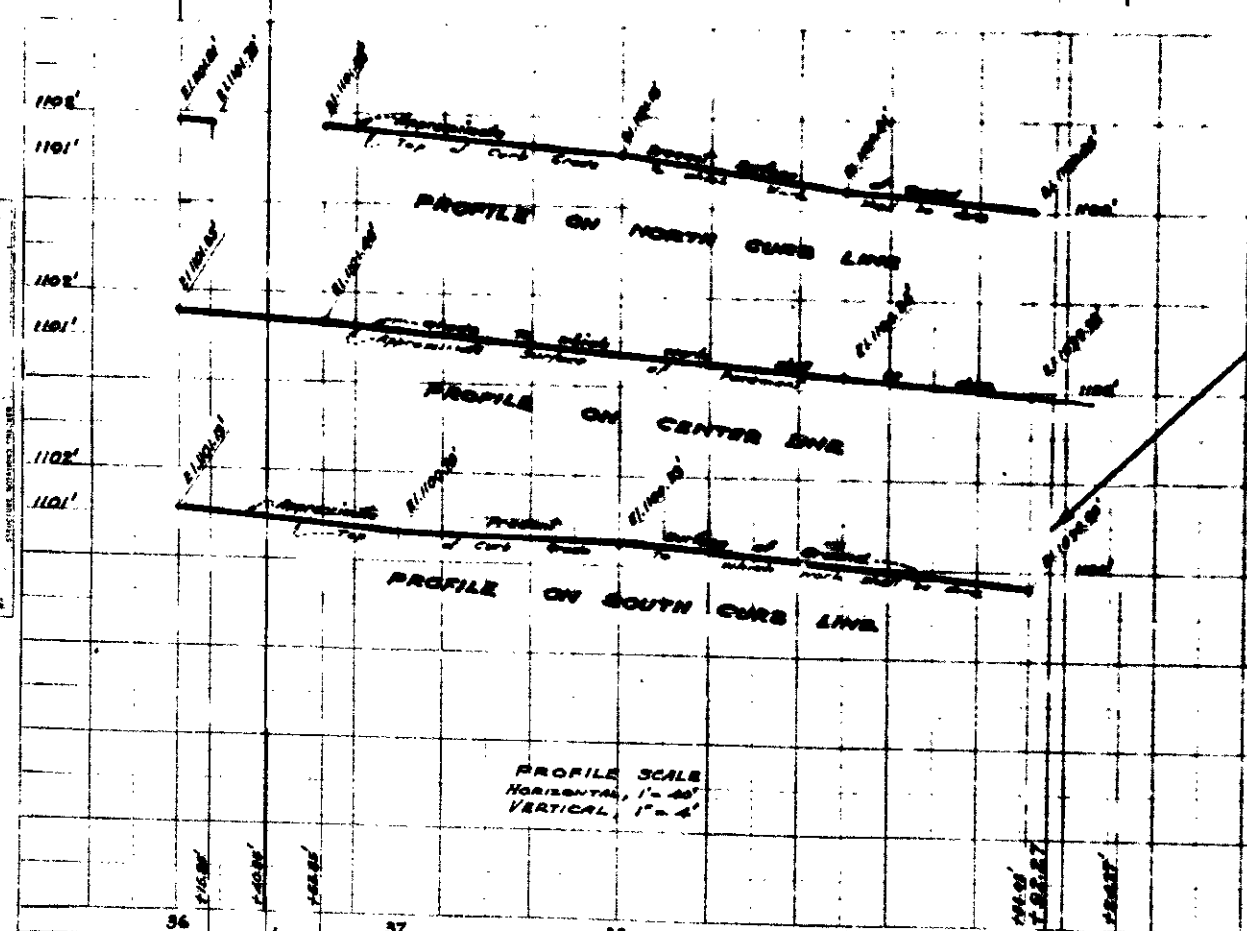
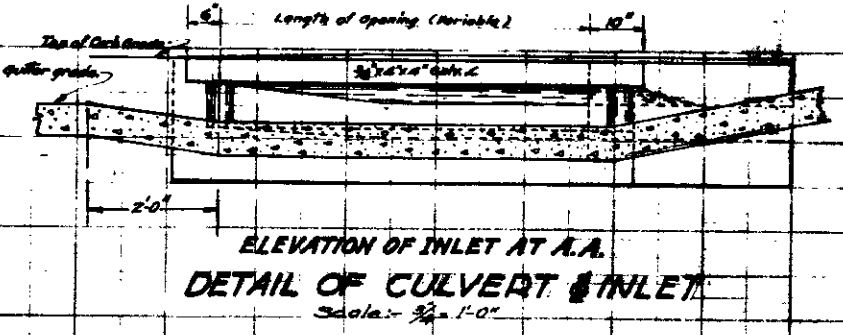

END OF PROJECT
 STATION - 39+92.27

R.D. Forsythe
 R.D. FORSYTHE
 Acting City Engineer
 Civil Eng. Cert. 1P3102

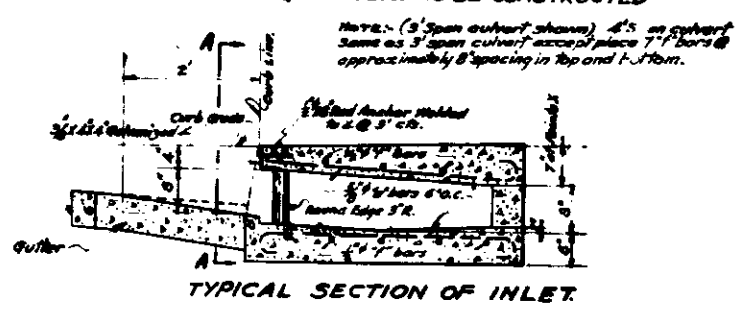
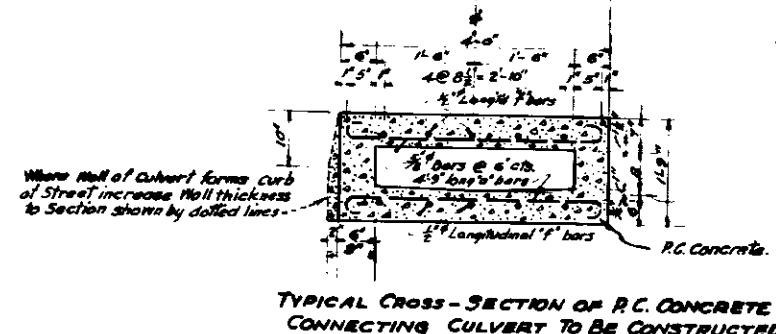
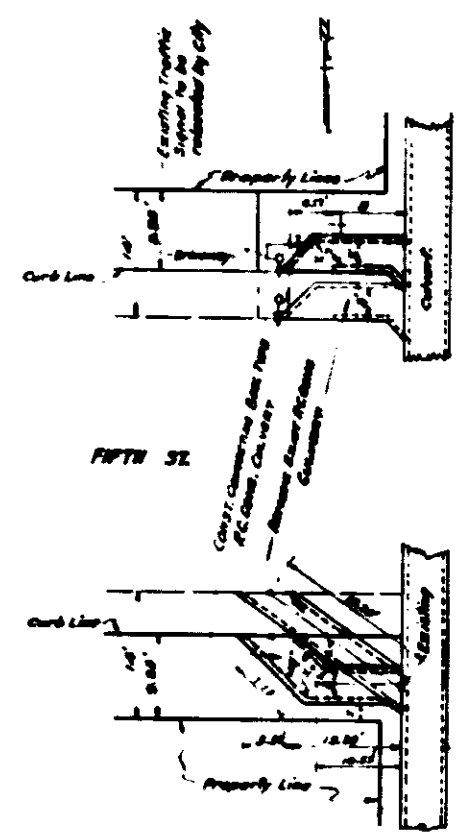
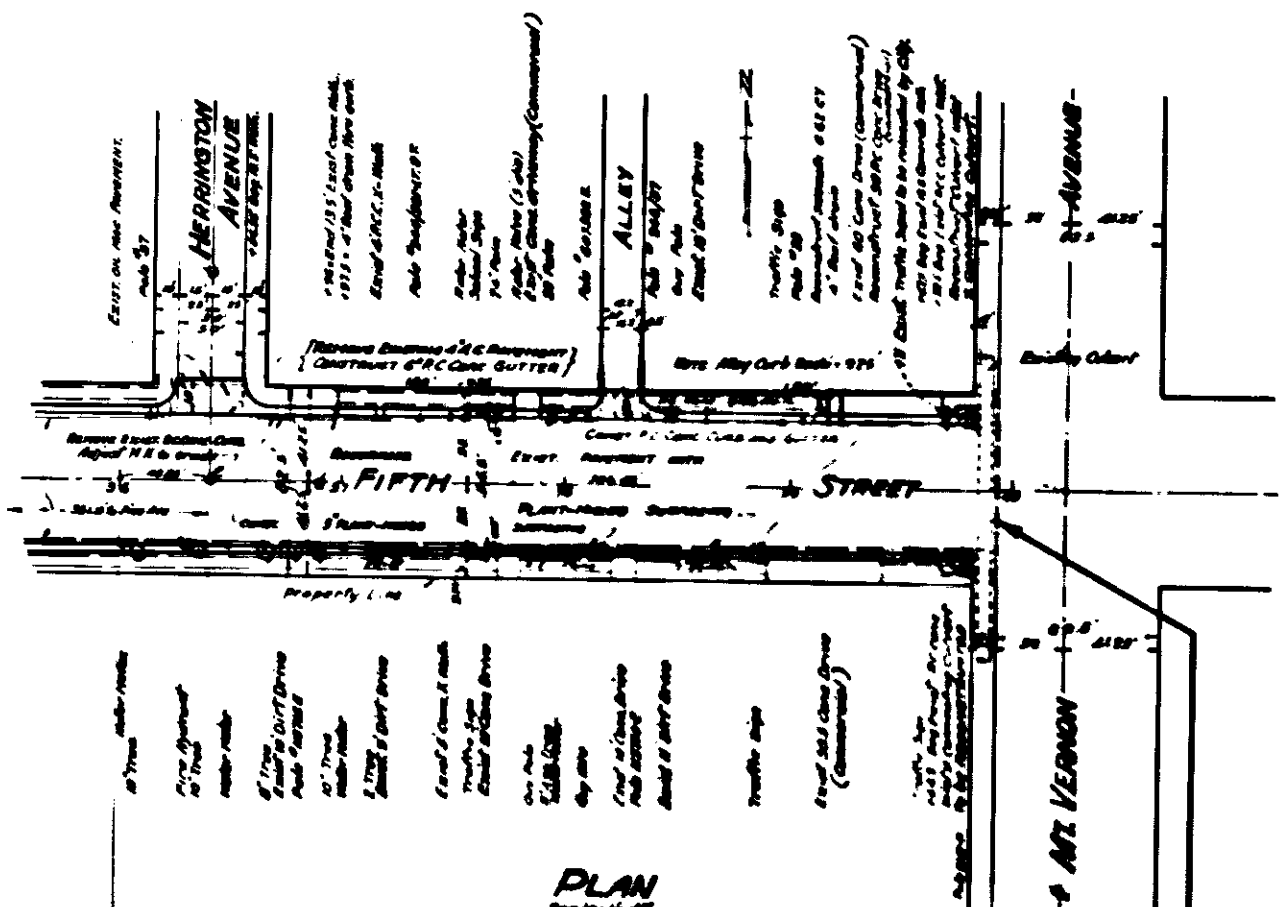

NOTE: Top of culvert in sidewalk area to conform to cross slope and finished grade and marking of sidewalk, opening thru curb to have corners rounded with a 3" radius.

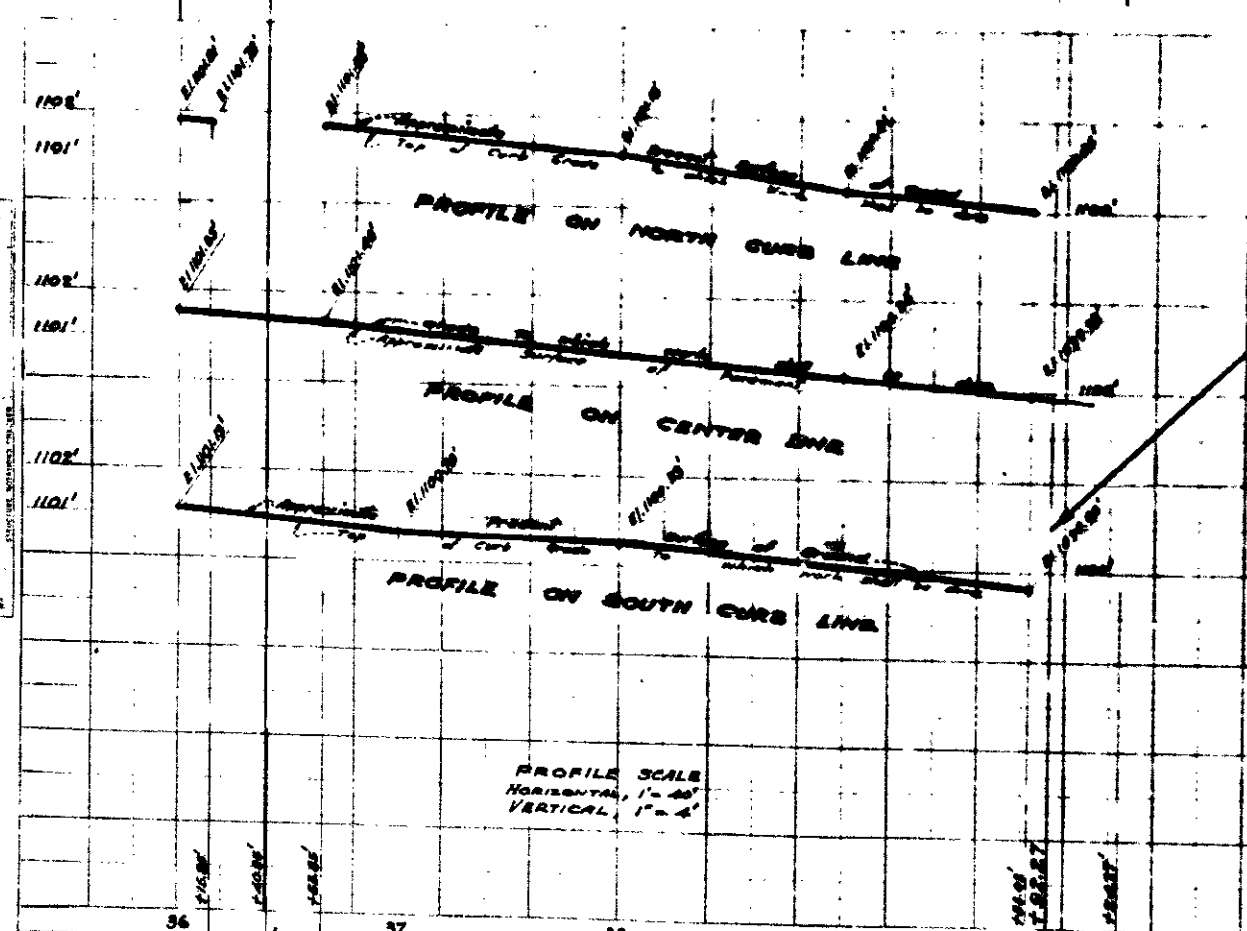
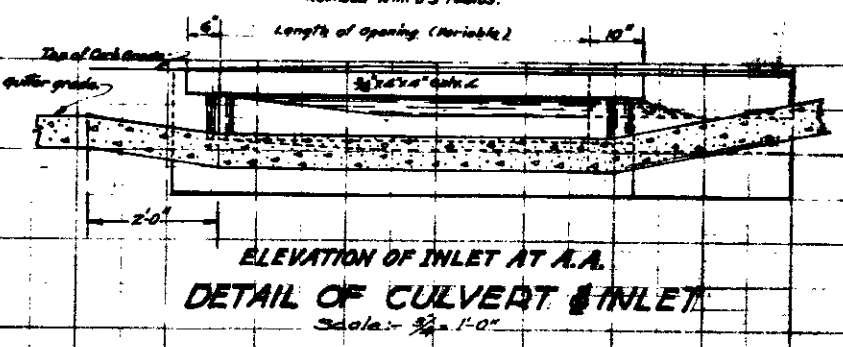

END OF PROJECT
 STATION - 39+92.27

PROFILE
 DATE: 1911
 DRAWN BY: [Name]
 CHECKED BY: [Name]